



PROFESSIONAL SLIDING PEDAL KIT



Visit our website for more information
www.wolfracing.eu

1

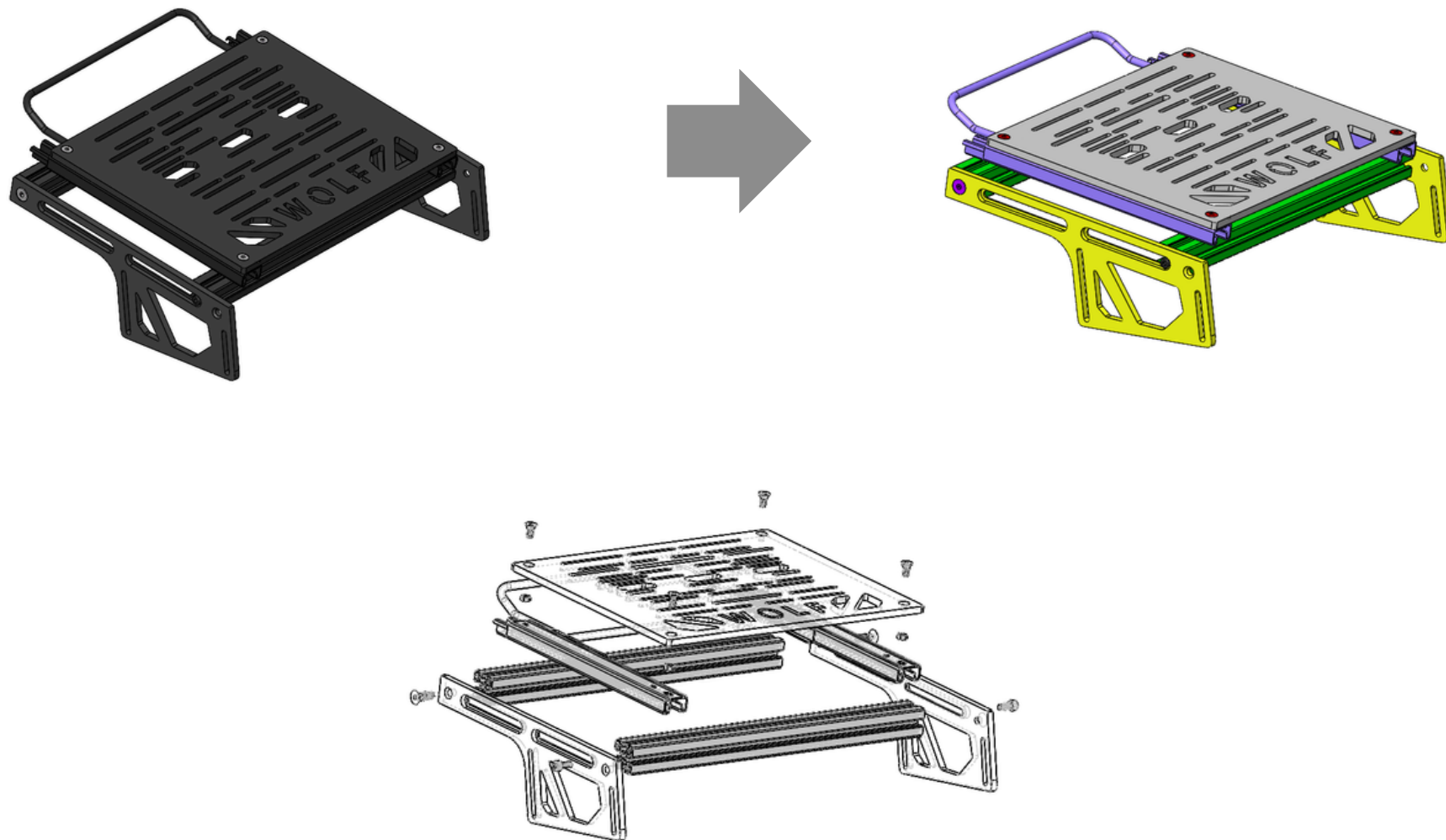

Kit components are shown in different colors for assembly.



--- KIT COMPONENTS ---



**M10x30 Countersunk Screw
(x4)**



**M8x20 Countersunk Screw
(x4)**



**M8x20 Socket Head Cap
(x4)**



**M10x30 Socket Head Cap
(x2)**



**M8 HEX Nut
(x4)**

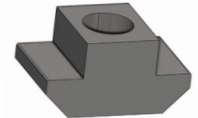

**M8 T-Slot Nut
(x4)**



40-40-579 (x1)

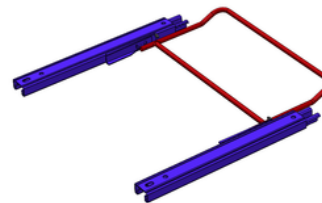

**Universal sliding kit
(x1)**

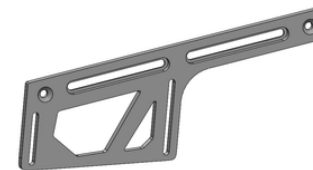

**Side connection plates
(x1) Left (x1) Right**

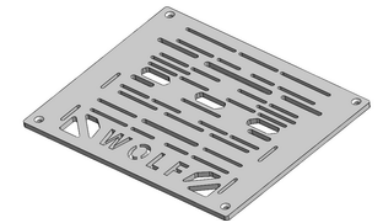

**Pedal plate
(x1)**

3

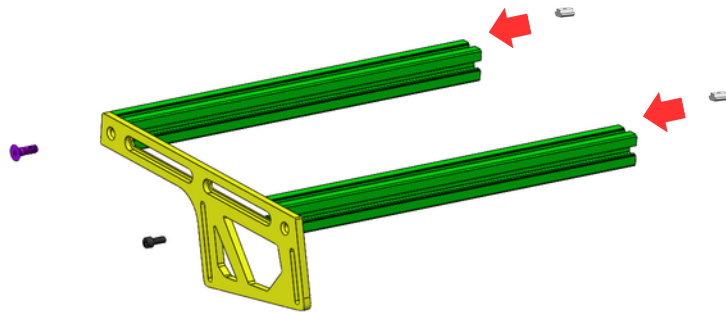

1

Connect the components shown in the figure (T-slot nut and M10 countersunk screw) with the given parts.

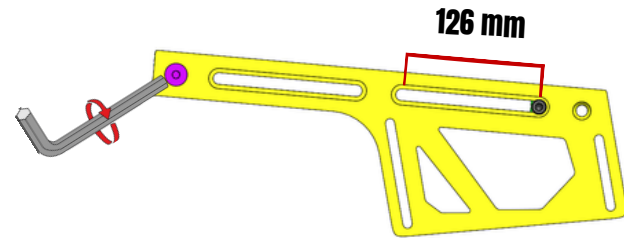

2

Adjust the M10 socket head cap screw to the dimensions given in the figure and tighten to secure.

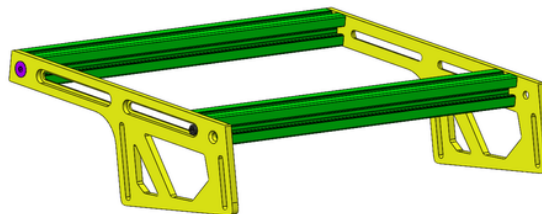

3

Perform the same process on the other side to prepare the bottom frame.

4

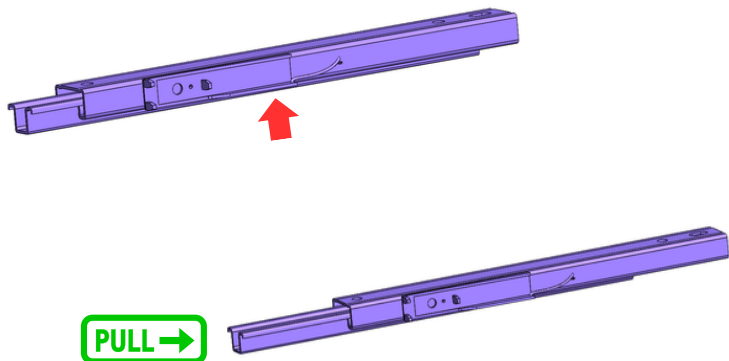

1

Apply force to the indicated part of the rail to make the mechanism swing and expose the hole on the bottom rail.

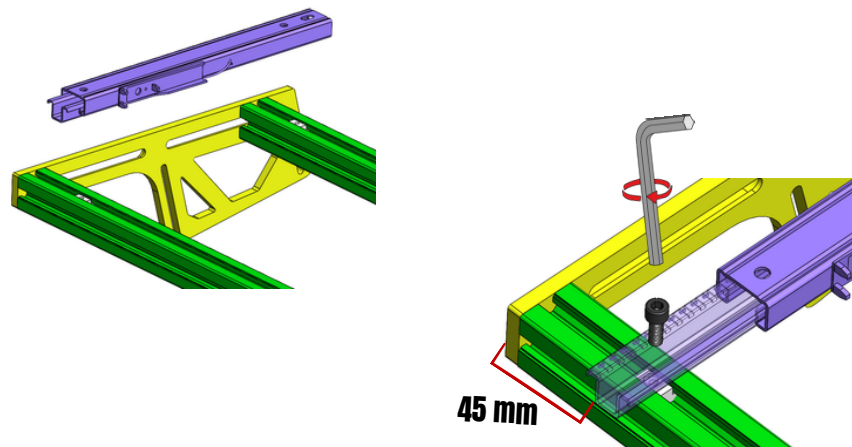

2

Attach the rail to the frame according to the specified distance.

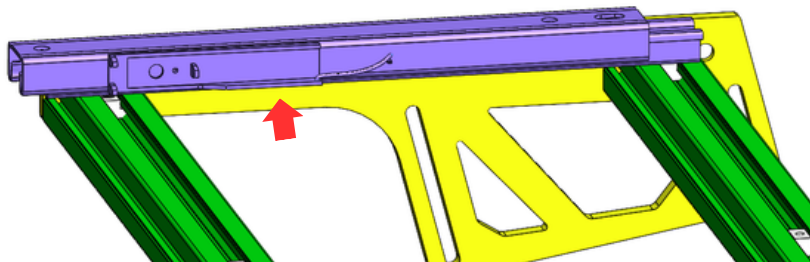

3

Apply force to the mechanism again, this time bringing the hole center at the back of the system to the front. Then secure that center to the frame at the same distance (45 mm).

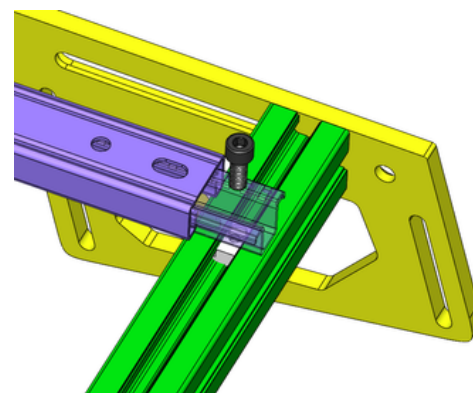

5

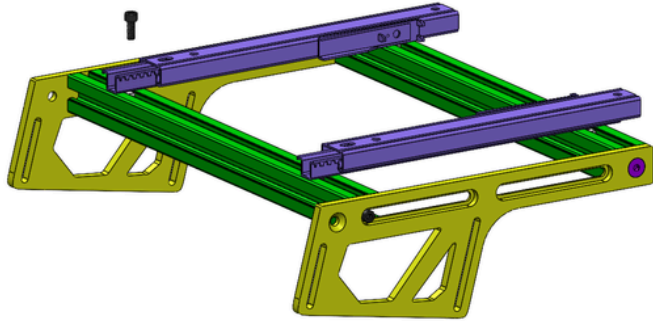

1

Secure the rear part of the second rail to the other side, ensuring the same distance with a slight gap (enough for the front of the rail to move).

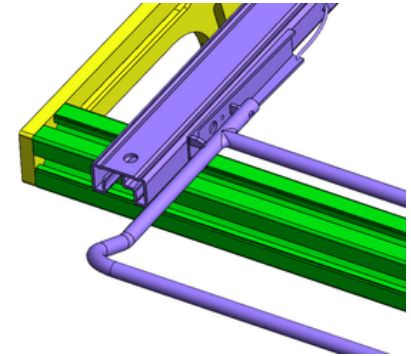
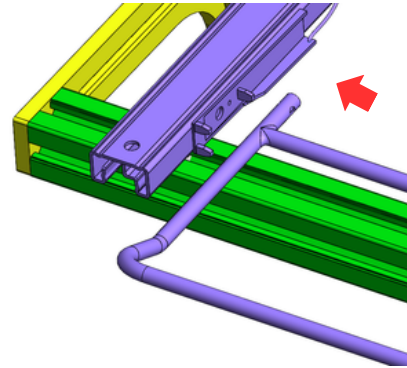

2

Insert the hole next to the rail bar into the protrusion on the rail system.

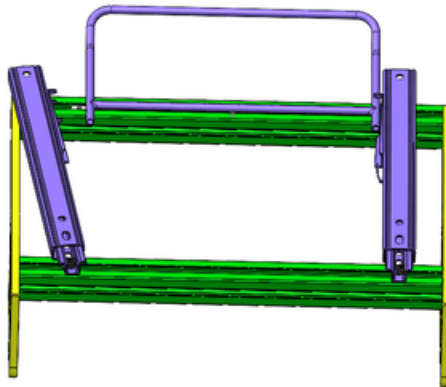

3

After inserting the protrusion on the second rail system into the hole next to the rail bar as shown in the figure, also secure the hole on the top part of the second rail system to the frame.

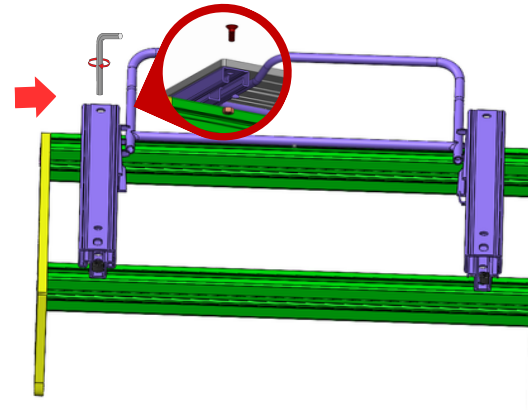

6

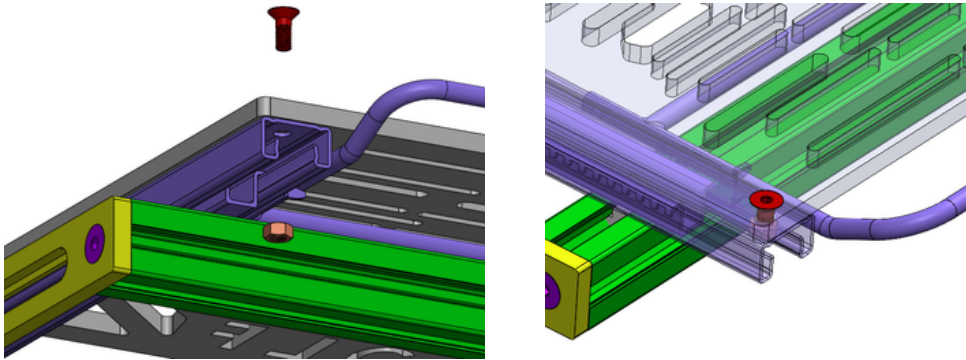

1

Attach the pedal plate to the holes on the upper parts of the rail using the components shown in the figure.

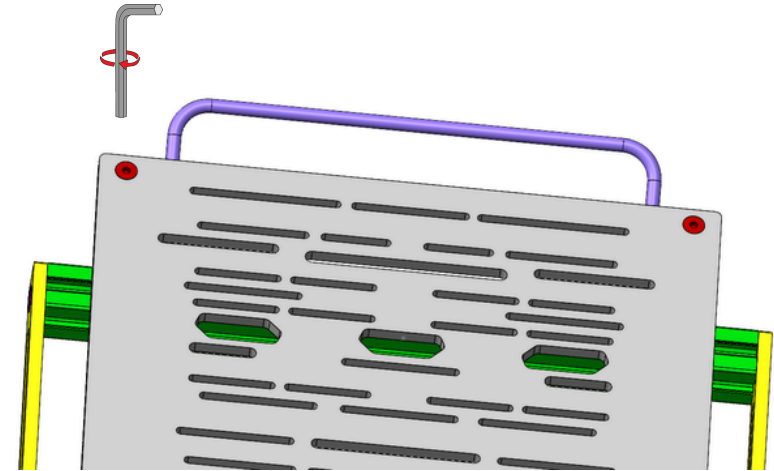

2

After applying the same process to the second rail system, tighten both rails securely using the hex key.

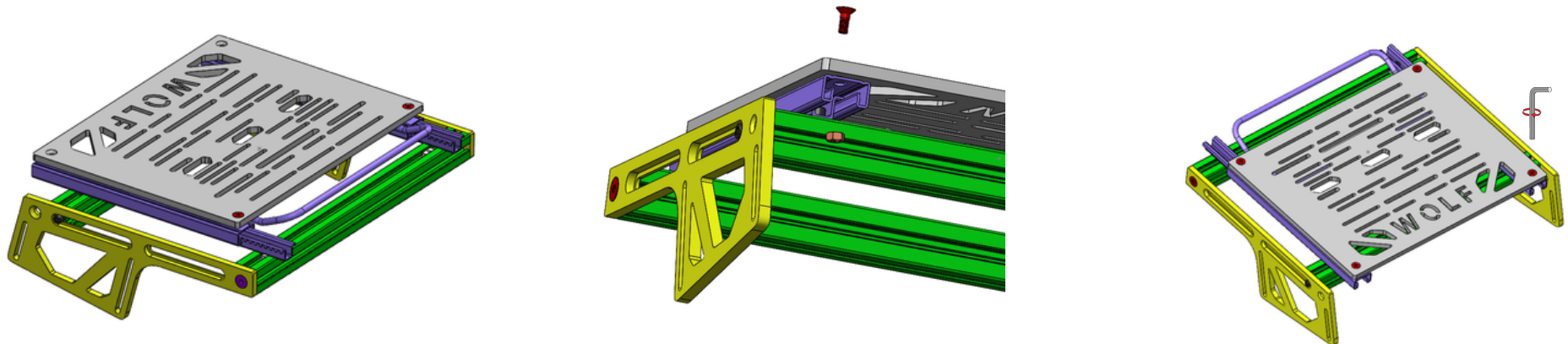

3

Pull the adjustment bar upwards to move the plate forward, then apply the same process to the rear holes to secure the plate.

